

Lower Mainland Horticultural Conference

January 23-25, 2025
TRADEX, Abbotsford

Presented by the B.C. Ministry of Agriculture and Food together with the Lower Mainland Horticultural Improvement Association and the Pacific Agriculture Show

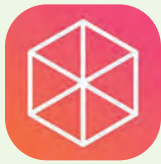

Available for Apple iOS, Android, and web-based browsers, the **vFairs Mobile App** will allow you to review conference sessions, speaker information, and more.

Pesticide Re-certification Credits

Pesticide re-certification credits are offered at this conference.

Lower Mainland Horticultural Improvement Association (LMHIA) members holding a valid Pesticide Applicators Certificate may earn credits towards re-certification by attending eligible sessions identified by a ladybug in the conference program.

To participate in the program a grower must:

- Maintain an annual membership in the LMHIA's Pesticide Re-certification Program
- Possess a current and valid 5-year Pesticide Applicators Certificate in the agriculture (general) category
- Be able to read and comprehend English pesticide labels

For more details, the application form/FAQ sheet can be requested by email: growers@agricultureshow.net



TRADEX Floorplan

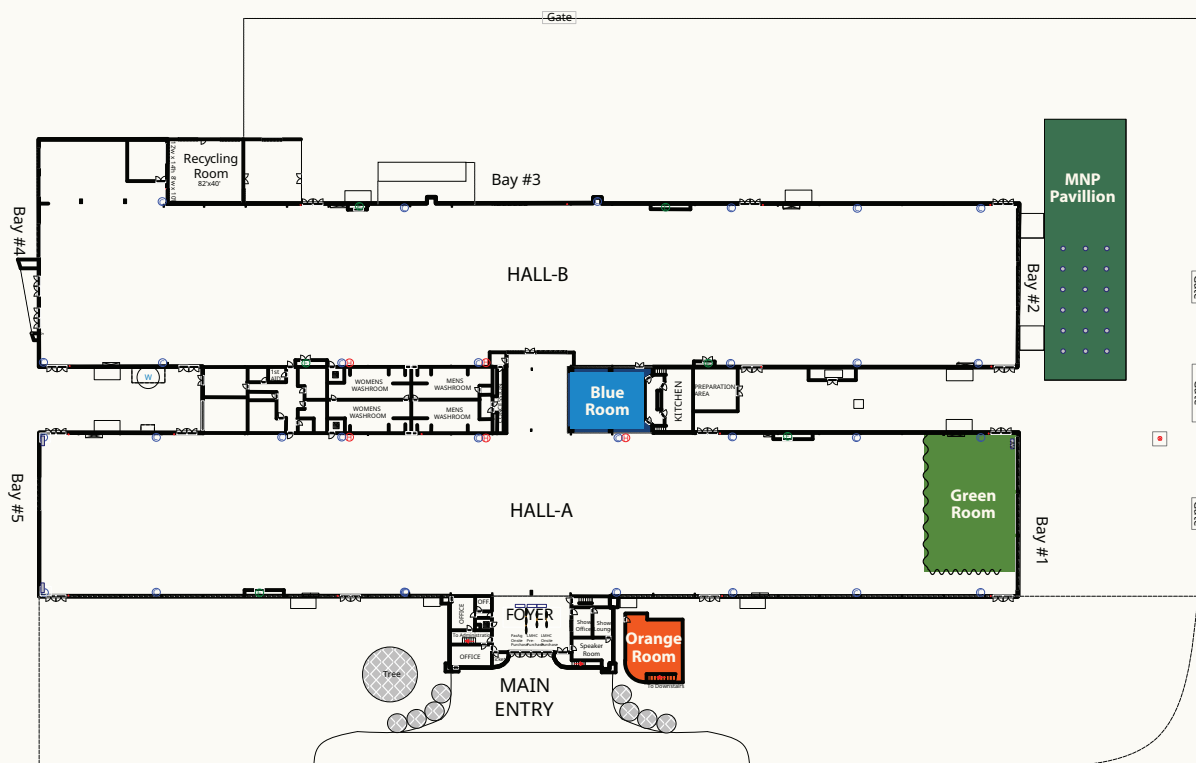

Legend

- W - Harvested Water Collection Unit
- ⚡ - Electrical Room
- ⊖ - Cold Water wall faucet with floor drain
- ⊕ - Hot/Cold Water wall faucet with Drain hookup

Floor plan for illustration purposes only.
Floor plan subject to change without notice.

| TIME | SESSION | ROOM |
|---------------------|--|------------|
| 8:00 AM – 4:00 PM | Registration | Lobby |
| 9:00 AM – 9:30 AM | Welcome and Opening Remarks B.C. Ministry of Agriculture and Food | Green Room |
| 9:30 AM – 10:15 AM | Plenary – Water: Agriculture and Community Approaches to Water Management in B.C. <i>Dr. Chris Bodnar, Assistant Professor, Agriculture, University of the Fraser Valley</i> Water management is a controversial topic in B.C. Severe and multi-year drought in recent years has highlighted the realities of the province’s relatively new regulatory system for water use, and has forced growers to adapt faster than many anticipated. This presentation will discuss how the agricultural sector can be a leader in water management through community engagement across the province. | Green Room |
| 10:15 AM – 10:30 AM | Morning Break | |
| 10:30 AM – 12:00 PM | Water <i>Chair: Tara Despault, B.C. Ministry of Agriculture and Food</i> | Green Room |
| 10:30 AM – 11:00 AM | Soil Moisture Essentials: How Can Soil-Water Dynamics Help Guide Irrigation Decisions? <i>Dr. Mark Johnson, Professor and Canada Research Chair, Institute for Resources, Environment and Sustainability and Department of Earth, Ocean and Atmospheric Sciences, University of British Columbia</i> Effective agricultural water management ensures that soil moisture aligns with crop demand. How do soil characteristics, crop stages, and weather dynamics impact soil moisture availability for planning healthy, high-quality harvests? | |
| 11:00 AM – 11:30 AM | Measuring Soil Moisture: Tools and Techniques for Precision Irrigation <i>German Barahona, Designer and Branch Manager - Oliver, Southern Irrigation</i> Dive into soil moisture, crop needs, and strategies for agricultural water management. Southern Irrigation will share practical insights into systems and sensors, strategic installation, how to interpret data to support precise irrigation decision-making, and more! | |
| 11:30 AM – 12:00 PM | Irrigation Scheduling 101 <i>Bruce Naka, Certified Irrigation Designer, Sound Water Advise and the Irrigation Industry Association of B.C.</i> The discussion will review fundamentals which comprise determining a crop’s irrigation requirements, then utilize this information to develop a custom irrigation system schedule. The presentation will include the use of tools available, such as the Agricultural Irrigation Scheduling Calculator. | |

| TIME | SESSION | ROOM |
|---------------------|--|--------------|
| 10:30 AM – 12:00 PM | Potatoes Chair: Leisa Yee, Administrator, B.C. Potato and Vegetable Growers Association Total Pesticide Re-certification Credits = 0.75 | Blue Room |
| | 10:30 AM – 10:50 AM 2025 B.C. Potato Variety Trial Highlights Heather Meberg, IPM Researcher/Consultant, ES Cropconsult Ltd. There is a bewildering variety of fresh market potato varieties available and under development. Annual variety trialing enables us to observe effects of growing conditions such as changing heat trends in the summer. | |
| | 10:50 AM – 11:25 AM New Tools to Improve the Timeliness of Nutrient and Water Management in Potatoes Andy Nadler, Agricultural Meteorologist, Peak Hydromet Solutions Marjolaine Dessureault, IPM Researcher/Consultant, ES Cropconsult Ltd. Hear about real-time tissue analysis and soil moisture sensors that help producers meet the growing needs of the crop during the growing season. What have we learned so far about how this can work for the industry? | |
| | 11:25 AM – 12:10 PM Blemishes of Potatoes – Management to Prevent the Scarring  Dr. Gary Secor, Researcher, North Dakota State University Blemish diseases such as scab, silver scurf, and black dot have been issues in table potatoes for some time. Some are newer than others, but all require understanding of the biology and management. Hear more about management tools and advice helpful to growers from a teacher, researcher and extension agent for the potato sector. | |
| 12:00 PM – 1:30 PM | Farm Business Management Chair: Gary Flaten, B.C. Ministry of Agriculture and Food | Orange Room |
| | 10:30 AM – 11:30 AM Managing Team Performance Dr. Richard Stup, Senior Extension Association, Cornell University The key to managing team performance is the Performance Triad: setting clear performance expectations, providing needed training and skill development, and providing motivational performance feedback. This presentation will share key leadership concepts and practical tools for applying them. | |
| | 11:30 AM – 12:00 PM Risky Business – Essentials for Success Heather Watson, Executive Director, Farm Management Canada Learn how to assess risk, plan proactively to minimize negative impacts, and seize opportunities for change. Hear about practical tools like the AgriShield Risk Assessment and Planning Platform. | |
| 12:00 PM – 1:30 PM | Lunch Break — Sponsored by TerraLink | MNP Pavilion |

| TIME | SESSION | ROOM |
|-------------------|---|------------|
| 1:30 PM – 2:45 PM | Raspberry/Strawberry Chair: Lisa Craig, B.C. Raspberry Council and B.C. Strawberry Growers' Association | Green Room |
| | 1:30 PM – 2:15 PM Strawberry and Raspberry Breeding Update Dr. Michael Dossett, Berry Breeder, B.C. Strawberry Growers' Association and B.C. Raspberry Council Wendy Hoashi-Erhardt, Director of Small Fruit Plant Breeding, Washington State University Hear an update on the performance of advanced selections and new cultivars from raspberry and strawberry breeding programs in B.C. and Washington. | |
| | 2:15 PM – 2:45 PM Substrate Production of Raspberries in the Fraser Valley James Bergen, Producer, Bergen Farms Transitioning from field production to soilless production of raspberries involves a steep learning curve. What are the challenges and opportunities with substrate production? | |
| 2:45 PM – 3:00 PM | Potatoes/Field Vegetables Chair: Karina Sakalauskas, B.C. Ministry of Agriculture and Food Total Pesticide Re-certification Credits = 1.25 | Blue Room |
| | 1:30 PM – 2:15 PM Optimizing Spray Applications in Vegetable Crops  Mark Ledebuhr, Principal Consultant, Application Insight LLC A fresh perspective on spray application in vegetables focused on improving minimum coverage and field capacity by mastery of first principles and focus on actionable strategies. Advanced technologies and strategies will also be introduced and discussed. | |
| | 2:15 PM – 2:45 PM Managing Cabbage Root Maggot – Hoping to Add to the Toolbox  Dr. Renee Prasad, Associate Professor and Department Head, University of the Fraser Valley Trials of important emergency registrations (Cimegra and Success) and Verimark for control of CRM on brassica crops (transplants and direct-seeded) have shown interesting, and hopefully promising, results. Hear where this multi-year research is moving for 2025. | |
| 3:00 PM – 4:15 PM | Afternoon Break | |
| 3:00 PM – 4:15 PM | Raspberry/Strawberry Chair: Lisa Craig, B.C. Raspberry Council and B.C. Strawberry Growers' Association Total Pesticide Re-certification Credits = 0.75 | Green Room |
| | 3:00 PM – 3:45 PM Soil-Borne Pests in California Strawberry: Challenges and Management Solutions  Dr. Oleg Daugovish, Strawberry and Vegetable Crop Advisor, University of California Integration of methods to improve cost-effectiveness of pathogen and weed management. This includes mapping and variable rate in-field fumigation, anaerobic soil disinfestation, cultivar resistance, timing of planting, planting hole steaming, and weed control methods. | |
| | 3:45 PM – 4:10 PM Market Outlook for Red Raspberries Ben Klootwyk, Account Manager, Pacific Coast Fruit Products What are the market prospects for B.C. raspberries in 2025? | |

| TIME | SESSION | ROOM |
|-------------------|--|-------------|
| 3:00 PM – 4:15 PM | Potatoes/Field Vegetables Chair: Karina Sakalauskas, B.C. Ministry of Agriculture and Food Total Pesticide Re-certification Credits = 0.75 | Blue Room |
| | 3:00 PM – 3:35 PM 2025 Vegetable Variety Highlights – What’s New for B.C.? – Panel PANELISTS: John Hart, Seed Representative, Stokes Seeds, Vancouver, B.C. Rebecca Morse, Seed Representative, West Coast Seed Ben Yurkiw, Seed Representative, Norseco Seeds Find out what’s available in the world of vegetable varieties from our seed representatives. | |
| | 3:35 PM – 4:10 PM Late Blight in Potatoes & Tomatoes: Still a Key Issue for B.C. and Canada  Dr. Rishi Burlakoti, Researcher, AAFC – Agassiz The pathogen causing late blight in potatoes is an aggressive strain that continues to require stringent management in B.C. Hear an overview of global/Canadian outbreaks of late blight, pathogen survey work, and what has been recently detected in B.C. and eastern provinces compared to historical findings. This work informs our understanding of fungicide resistance problems and management advice for late blight. | |
| | Organics Chair: Harvie Snow, Snow Farms Total Pesticide Re-certification Credits = 1.5 | |
| 3:00 PM – 3:45 PM | Spray Optimization in Fruits and Vegetables  Mark Ledebuhr, Principal Consultant, Application Insight, LLC A deep dive into the fundamentals of good spraying and spray coverage in ways that will make you re-think how you conduct your spray program. Optimization strategies for current technology, novel technologies, and practical strategies anyone can do to increase coverage. | Orange Room |
| | 3:45 PM – 4:15 PM Strategies for Spraying Alternative Materials  Mark Ledebuhr, Principal Consultant, Application Insight, LLC Sprayers were never designed for modern organic materials, but that doesn't mean they can't be sprayed effectively. This session will include strategies for spraying pheromones, living organisms such as nematodes, eggs, compost teas, and an overview of electrostatic technology. | |
| 4:15 PM | End of Conference Day 1 | |

| TIME | SESSION | ROOM |
|---------------------|---|------------|
| 8:00 AM – 4:00 PM | Registration | Lobby |
| 9:15 AM – 9:30 AM | Welcome & Opening Remarks <i>Seychelle Cushing, Executive Director, B.C. Centre for Agritech Innovation (BCCAI)</i> | Green Room |
| 9:30 AM – 10:15 AM | Plenary – Innovation: On-Farm Technology Adoption Panel MODERATOR AND PANELIST: <i>Bryan Wattie, Director of Agritech Adoption, Innovate BC</i> PANELISTS: <i>Chris Bodnar, Co-Owner, Close to Home Organics</i> <i>Michel Van Eekelen, Partner, Van Eekelen Enterprises</i> <i>Andrew Budgell, Co-Founder of Laughing Crow Organics</i> <i>Raj Hayre, Director of Special Projects, Randhawa Farms</i> Listen to the experiences in adopting technology directly from farmers. | Green Room |
| 10:15 AM – 10:30 AM | Morning Break | |
| 10:30 AM – 12:00 PM | Innovation <i>Chair: Seychelle Cushing, Executive Director, B.C. Centre for Agritech Innovation (BCCAI)</i> | Green Room |
| 10:30 AM – 11:10 AM | Empowering B.C.'s Farms: The AI Advantage in Agriculture Panel MODERATOR AND PANELIST: <i>Rahul Singh, Director, B.C. Centre for Arigtech Innovation (BCCAI)</i> PANELISTS: <i>Sukh Kahlon, Director, Kahlon Farms</i> <i>Leo Benne, Director, Bevo Farms</i> <i>Ruben Houweling, Operations Manager, Houweling Greenhouses</i> <i>Chris Payne, COO and CFO, 4ag Robotics</i> Explore real-world examples of how farmers in B.C. are using AI to solve everyday challenges, improve efficiency, and transform farm operations today. | |
| 11:10 AM – 11:15 | Transition Break | |
| 11:15 AM – 12:00 PM | Farm Forward: Navigating Technology Adoption with Insight and Confidence <i>Bryan Wattie, Director of Agritech Adoption, Innovate BC</i> <i>Rupee Besla, Manager of Business Development in the Lower Mainland, FCC</i> Innovate BC and Farm Credit Canada invite you to a unique workshop designed to empower farmers in evaluating and adopting new technologies. Reflect on a century of agricultural innovations and lessons learned, then dive into actionable case studies and a structured approach to assessing new tools. Farm Credit Canada will wrap up with expert advice on preparing financially for future tech investments on the farm. | Green Room |

| TIME | SESSION | ROOM |
|---------------------|--|--------------|
| 10:30 AM - 12:00 PM | Floriculture/Ornamentals Chair: Michel Benoit, CEO, United Flower Growers Cooperative Total Pesticide Re-certification Credits = 0.75 | Orange Room |
| | 10:30 AM - 11:15 AM Taking Advantage of Marketplace Trends in the Floriculture and Ornamentals World - Panel MODERATOR: Michel Benoit, CEO, United Flower Growers Cooperative PANELISTS: Leanne Johnson, President, Gardenworks Andries Quik, CEO, Quik's Farm Dave Van Belle, President, Van Belle Nursery Jack Rozendaal, Executive VP, DeVry Greenhouse | |
| | 11:15 AM - 12:00 PM Integrated Pest Management (IPM) Strategies for Thrips in Greenhouse Ornamentals  Mario Lanthier, IPM Consultant & Researcher, Crop Health Advising and Research Thrips pose a significant challenge across a wide range of crops, especially in greenhouse environments, where management can be complicated by insecticide resistance and the introduction of new species. This presentation will explore the biology of thrips, with an emphasis on effective management tactics, including the latest insecticide options and the integration of biocontrol agents for sustainable pest control. | |
| 12:00 PM - 1:30 PM | All Berry Chair: Michael Dossett, B.C. Blueberry Council, B.C. Raspberry Council and B.C. Strawberry Growers' Association | Blue Room |
| | 10:30 AM - 10:55 AM Drip Line Installation and Maintenance in Blueberry Fields Peter Torenvliet, Branch Manager - Chilliwack, Southern Irrigation Join Southern Irrigation in exploring practical approaches to drip line installation in blueberry fields, applicable to other commodities as well. This presentation will cover effective techniques for system setup, maintenance, and water delivery optimization. | |
| | 10:55 AM - 11:25 AM Soil Moisture Sensors to Optimize Irrigation Andy Nadler, Agricultural Meteorologist, Peak HydroMet Solutions A review of various soil moisture sensors and how to leverage the information to improve water management in blueberries. | |
| | 11:25 AM - 12:00 PM Interpreting Your Soil Analysis Report Josh Andrews, Nutrient Management Specialist, B.C. Ministry of Agriculture and Food What are the key areas to review on your soil analysis report? How can you use soil analysis and leaf tissue analysis to determine the fertilizer needs of your berry crop in the following season? | |
| 12:00 PM - 1:30 PM | Lunch Break — Sponsored by TerraLink | MNP Pavilion |

| TIME | SESSION | ROOM |
|-------------------|--|------------|
| 1:30 PM – 2:45 PM | All Berry Chair: Carolyn Teasdale, B.C. Ministry of Agriculture and Food Total Pesticide Re-certification Credits = 0.75 | Green Room |
| | 1:30 PM – 2:00 PM 2021 Heat Dome: What Did We Learn and How Do We Deal with High Temperatures in the Future? Dr. David Bryla, Research Horticulturalist, United States Department of Agriculture Re-visit the heat dome and its impact on fruit loss in blueberry, blackberry and raspberry, and hear a refresher on heat mitigation strategies. | |
| | 2:00 PM – 2:45 PM Spray Like You Mean it: Optimizing Spray Strategies in Berry Crops  Mark Ledebuhr, Principal Consultant, Application Insight LLC Learn about actionable strategies to increase spraying success. We'll cover optimal use of conventional sprayers through to some of the newest and most promising upcoming technologies and give you decision support tools to help determine what's right for your operation. | |
| | Hazelnut Chair: Zach Fleming, Pacific Coast Agriculture | Blue Room |
| | 1:30 PM – 2:25 PM Growing Hazelnuts: Lessons from Oregon Dr. Nik Wiman, Professor, Oregon State University Key insights and research updates from Oregon's hazelnut industry, focusing on orchard management, disease control, and sustainability. Learn practical strategies to enhance hazelnut production based on the latest findings and Oregon's experience. | |
| | 2:25PM – 2:45 PM Hazelnut Market Outlook Kevin Hooge, Co-owner, Fraser Valley Hazelnuts Ltd. Steve Hope, Co-owner, Fraser Valley Hazelnuts Ltd. Perspectives from a B.C. packer. Hear about trends in the local and international market. | |

| TIME | SESSION | ROOM |
|-------------------|---|-------------|
| 1:30 PM – 2:45 PM | Greenhouse Vegetable Chair: Gary Jones, B.C. Greenhouse Growers' Association Total Pesticide Re-certification Credits = 0.5 | Orange Room |
| | 1:30 PM – 1:55 PM Executive Coaching and Business Management Tim Dumas, Executive Strategy Coach, Servus Leadership Inc., Business Coaching An overview of the business management skills and strategies that owners and operators of greenhouse vegetable facilities may utilize in more effectively running their businesses and managing their staff. | |
| | 1:55 PM – 2:20 PM Greenhouse Pepper Fusarium Rot Update  Cara McCreary, Greenhouse Vegetable IPM Specialist, Ontario Ministry of Agriculture, Food, and Rural Affairs An update on research and findings regarding greenhouse pepper fusarium rot; mitigation practices and control methods. | |
| | 2:20 PM – 2:45 PM Application of Artificial Intelligence (AI) in Commercial Greenhouses Dr. Youbin Zheng, Professor, School of Environmental Sciences, University of Guelph An overview of how AI may already be being used in greenhouse vegetable production, or how it may be applied to the sector as it's development advances in the future. | |
| 2:45 PM – 3:00 PM | Afternoon Break | |
| 3:00 PM – 4:15 PM | Blueberry Chair: Paul Pryce, B.C. Blueberry Council | Green Room |
| | 3:00 PM – 3:25 PM How Much Water is Needed for Young Blueberries? Dr. David Bryla, Research Horticulturalist, United States Department of Agriculture Continuous and direct measurements of blueberry water uptake over the season, to help determine more precise irrigation timings. | |
| | 3:25 PM – 3:50 PM BerrySmart Blueberry Fields Steve Mantle, Founder and CEO, Innov8.ag Learn about the U.S. Highbush Blueberry Council's BerrySmart project and the results from field testing new technologies in commercial blueberry fields. | |
| | 3:50 PM – 4:15 PM Nutrient Sap Analysis: Optimizing Blueberry Health and Yield Rick de Jong, International Business Development Manager, Agro-K How sap field data can show emerging trends and issues impacting blueberry crop nutrition. | |

| TIME | SESSION | ROOM |
|-------------------|--|-------------|
| 3:00 PM – 4:15 PM | Hazelnut Chair: Zach Fleming, Pacific Coast Agriculture Total Pesticide Re-certification Credits =0.5 | Blue Room |
| | 3:00 PM – 3:30 PM Safeguarding Orchards: The Critical Role of Disease Management  Dr. Siva Sabaratnam, Plant Pathologist, B.C. Ministry of Agriculture and Food Learn key strategies for preventing and controlling diseases in orchards. | |
| | 3:30 PM – 4:15 PM Overview of Chilean Hazelnut Industry, Orchard Management and Technologies Used in Chile Jorge Mohr, Co-Founder and Director, Nefuen Trading An overview of the Chilean hazelnut industry, focusing on orchard management and the technologies driving sustainable production. | |
| | Greenhouse Vegetables Chair: Industry Development, B.C. Greenhouse Growers' Association Total Pesticide Re-certification Credits = 1.0 | |
| 3:00 PM – 3:25 PM | Innovations in Hygiene Management Against Tomato Brown Rugose Fruit Virus (ToBRFV)  Dr. Jens Ehlers, Scientific Sales Advisor and Hygiene Expert for Greenhouses, Menno Chemie Vertrieb GMBH, Germany New strategies and technologies to prevent the spread of ToBRFV, focusing on advanced sanitation practices, resistant plant varieties, and monitoring systems to protect crops. | Orange Room |
| | 3:25 PM – 3:50 PM Substrate Sensor Technologies  Dr. Mark Lefsrud, Associate Professor, McGill University An update on current and upcoming new technology as it relates to substrate sensor equipment (conductivity, moisture, etc.) in application to greenhouse vegetable production. | |
| | 3:50 PM – 4:15 PM New Energy in Commercial Greenhouse Production Dr. Majid Bahrami, Professor, Simon Fraser University A review of alternative energy sources being applied to greenhouse vegetable production to reduce costs and increase efficiency of energy usage, as well as reduce greenhouse gas emissions. | |
| 4:15 PM | End of Conference Day 2 | |

| TIME | SESSION | ROOM |
|---------------------|--|-------------|
| 8:00 AM – 12:00 PM | Registration | Lobby |
| 9:15 AM – 10:45 AM | <p>Blueberry</p> <p>Chair: Humraj Kallu, B.C. Blueberry Council</p> <p>Total Pesticide Re-certification Credits = 0.5</p> | Green Room |
| 9:15 AM – 9:30 AM | <p>Blueberry Scorch Virus Testing Update </p> <p>Dr. Peter Ellis, Laboratory Director, Phyto Diagnostics Company Ltd.</p> <p>Phyto Diagnostics Company tests thousands of blueberry samples from the B.C. blueberry industry. What trends are they seeing in virus testing results from 2024?</p> | |
| 9:30 AM – 9:45 AM | <p>Spread of Blueberry Scorch Virus in Commercial Blueberry Fields in B.C. </p> <p>Carolyn Teasdale, Industry Specialist, B.C. Ministry of Agriculture and Food</p> <p>How fast has blueberry scorch virus spread over the past three years in Abbotsford blueberry fields with good aphid management?</p> | |
| 9:45 AM – 10:00 AM | <p>B.C. Blueberry Breeding Program Update</p> <p>Dr. Michael Dossett, Berry Breeder, B.C. Blueberry Council</p> <p>Hear an update on the performance of advanced blueberry selections from the B.C. breeding program.</p> | |
| 10:00 AM – 10:45 AM | <p>Maintaining New Blueberry Fields in Good Health – Panel</p> <p>MODERATOR: Paul Pryce, Executive Director, B.C. Blueberry Council</p> <p>PANELISTS:</p> <p>Doug McCann, Sales Manager, Oregon Blueberry Farms and Nursery</p> <p>Mark Sweeney, Consulting Horticulturalist</p> <p>David Mutz, Producer and Packer, Berry Haven Farms</p> <p>Harry Sidhu, Nursery Manager, Sidhu Growers</p> <p>A panel discussion on the best practices for growing and harvesting blueberries to ensure healthy plants and high yields while prioritizing fruit quality.</p> | |
| | <p>Organics</p> <p>Chair: Heather Meberg, E.S. Cropconsult Ltd.</p> <p>Total Pesticide Re-certification Credits = 0.5</p> | Orange Room |
| 9:15 AM – 9:50 AM | <p>Estimating Plant Available Nitrogen Release from Cover Crops</p> <p>Jesse Way, Producer, Milky Way Farm</p> <p>An overview of Milky Way Farm's on-farm demonstration research project measuring the nitrogen release from cover crops and how it has changed their management strategies.</p> | |
| 9:50 AM – 10:15 AM | <p>Nutrient Management</p> <p>Josh Andrews, Nutrient Management Specialist, B.C. Ministry of Agriculture and Food</p> <p>Overview of how to use the B.C. Nutrient Management calculator, the importance of post-harvest nitrate sampling, and programs to support on-farm nutrient management planning.</p> | |
| 10:15 AM – 10:45 AM | <p>Organic Control Strategies for Brassica Diseases </p> <p>Katie Goldenhar, Plant Pathologist, B.C. Ministry of Agriculture and Food</p> <p>Overview of common brassica disease and organic control strategies.</p> | |

| TIME | SESSION | ROOM | |
|---------------------|--|-------------|--|
| 10:45 AM - 11:00 AM | Morning Break | | |
| 11:00 AM - 12:30 PM | Blueberry Chair: Carolyn Teasdale , <i>B.C. Ministry of Agriculture and Food</i> Total Pesticide Re-certification Credits = 0.25 | Green Room | |
| | 11:00 AM - 11:30 AM | | Pollination Insights: Updates on Blueberry Pollination Research Dr. Lisa Wasko DeVetter , <i>Associate Professor, Small Fruit Horticulture, Washington State University</i> Learn about the latest research on honeybee stocking density, placement, and new tools to inform pollination decisions on blueberry farms. |
| | 11:30 AM - 12:00 PM | | Integrating Habitat for Bees and Beneficial Insects on Blueberry Farms  George Kaufman , <i>Crop Advisor, AgriCare Inc.</i> Hear first-hand experience about how to select, install, and maintain pollinator habitat on blueberry farms to support pollinator and beneficial insect populations. |
| | 12:00 PM - 12:30 PM | | Global Trends in Blueberry Production and Markets Cort Brazelton , <i>Co-CEO, Fall Creek Nursery</i> Micah Weiss , <i>Area Manager, Fall Creek Nursery</i> Fruit quality is of increasing importance in global and local blueberry markets. What strategic advantages do growers in the Pacific Northwest have to optimize yields and fruit quality while lowering unit costs. |
| | Organics | | |
| 11:00 AM - 12:30 PM | Tractor Mounted Weeding Equipment - Farmer Panel MODERATOR: Sarah Stewart , <i>Organic BC</i> PANELISTS: Chris Bodnar , <i>Co-Owner, Close to Home Organics</i> Matt Carr , <i>CEO, Cultivate Horticulture</i> Harvie Snow , <i>Producer, Snow Farms</i> An overview of tractor mounted weeding equipment available for B.C. producers. Producer panelists will share their experiences with the Thiessen Cultivator, Stout Smart Cultivator as well as more traditional tools. | Orange Room | |
| 12:30 PM | End of Conference Day 3 | | |

2024/2025 LMHIA Directors

Blueberry

Nancy Chong
Greg Neger
Kerry Seale

Organic

Lydia Ryall
Harvie Show
Vacancy

Raspberry

James Bergen
David Mutz
Jordan Alamwala

Strawberry

Amir Mann
Jeff Husband
Alf Krause

Vegetable

Marinus van Eekelen
Tristin Bouwman
Bruce Wisbey

Hops

Sam Glasgow

Agribusiness

Grant McMillian
Heather Meberg
Leah Erickson

Hazelnuts

Zach Fleming

Ex Officio Directors

Michael Dossett (*Berry Breeder/ Geneticist*)
Gary Jones (*Consultant*)
Charitha Jayasinghe (*AAFC Agassiz*)
Todd Kabluk (*AAFC Agassiz*)
Rishi Burlakoti (*AAFC Agassiz*)
Wim Van Herk (*AAFC Agassiz*)
Rajiv Dasanjh (*BCMAF*)
Susan Smith (*BCMAF*)
Karina Sakalauska (*BCMAF*)
Carolyn Teasdale (*BCMAF*)
Gary Flaten (*BCMAF*)

Administrator

Leisa Yee

Industry Association Partners



Presented By



Thank You to Our Sponsors

GOLD SPONSOR

TerraLink

BRONZE SPONSORS

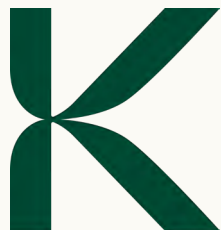

Koppert



Genomics positively impacts life, every day.



Funding for the conference is provided in part by the governments of Canada and British Columbia through the Sustainable Canadian Agricultural Partnership, a federal-provincial-territorial initiative.